

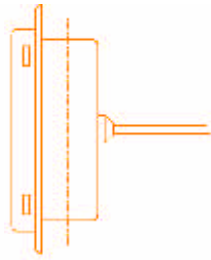

G

Remote thermometer for panel surface mounting - Back flange



H

Remote thermometer for panel flush mounting - Front flange

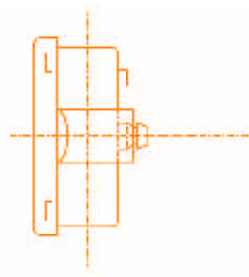

I

Remote thermometer for panel flush mounting - U-Clamp

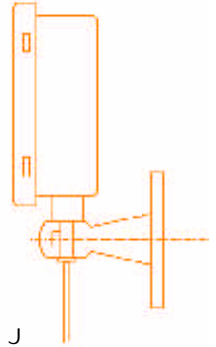

J

Remote thermometer for wall mounting - Bracket



M

Mobile union grand



U

Cap swivel



UF

Cap swivel on capillary

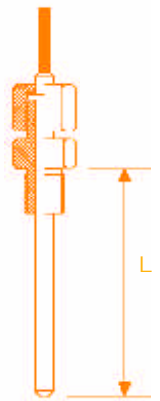

UC

Cap nut and union nut



625.000

Remote thermometers standard

Ø Dimensions:
2-1/2", 3", 4", 5", 6", 8", 10"
Measuring system:
Mercury, organic liquid
Case:
Steel or aluminium black enameled
Capillary:
Steel or copper, length as requested
Bulb:
Brass steel, stainless steel
Ø 1/4"...1/2"
Connection:
BSP / NPT / Metric
Various ranges:
-70...+650°C
Accuracy:
+/- 1, 1.5, 2%
depending on measuring system



626.000

Remote thermometers stainless steel

Ø Dimensions:
2-1/2", 3", 4", 5", 6"
Measuring system:
Mercury, inert gas
Case:
AISI 304 - waterproof
Capillary:
AISI 316
Bulb:
AISI 316 Ø 1/4"...1/2"
Range:
-70...+650°C
Accuracy:
+/- 1%
Electr. contacts:
drag or magnetic contacts